



The **WISE** Choice

EASTMAN WORLD

Welcome to Eastman World - Your Global Partner in Energy Solutions!



POWER SOLUTION

HOME INVERTERS & UPS | ELECTRICAL ACCESSORIES

Eastman Introduction

Founded in 2006

Established in 2006, Eastman Auto & Power Limited is a well-known name in the field of solar energy, energy storage, and power electronics, boasting a USD 300 million revenue and a dedicated workforce of over 3,000 professionals. Building on the group's decades-long success and maintaining the trust of our partners, Mr. Jagdish Rai Singal ventured into the future of energy with Eastman Auto & Power Limited. Today, the business spans over 25 countries across Asia and Africa, providing the world with cutting-edge products that have set new benchmarks in their respective segments. Driven by innovation, we continually set industry standards, ensuring uninterrupted power supply for residential, commercial, and industrial applications.

Our global solar distribution business provides reliable and high-quality solar solutions, including solar inverters, solar panels, solar batteries (tubular, carbon, gel and lithium) solar pump inverters, solar charge controllers, and more. Our products offer a range of solutions to help you make the switch to clean energy. With us as your unwavering partners, we forge a sustainable future, amplifying global excellence through transformative products and services.



CONTENT

EXPLORE OUR CATALOGUE FOR TOP-QUALITY ENERGY STORAGE AND SOLAR SOLUTIONS DESIGNED TO MEET YOUR NEEDS.

POWER SOLUTION

1. HOME INVERTERS 04

2. ONLINE UPS 07

3. SURGE PROTECTOR 15





SINE WAVE - HOME INVERTER

900VA ~ 5500VA

Introduction

Our Sine Wave Home Inverter is the perfect solution to ensure your home stays powered up efficiently and seamlessly. Designed to provide clean and stable power, it ensures the smooth functioning of all your devices, from sensitive electronics to essential appliances.

Product Features

- Unity power factor VA=WATT (*Bulb load)
- Peak load peak output (PLPO)
- Start & Run compressor load/motor load as per rating
- Full load output voltage highest among its peers @ nominal battery voltage
- Zero Volt pick up
- Start & Run SMPS load (LED Lights) as per rating

Product Specifications

MODEL NAME	SINO 900VA	SINO 1200VA	SINO 1800VA	SINO 2500VA	SINO 4000VA	SINO 5500VA
Voltage	12V		24V		48V	
UPS BACKUP MODE TESTING						
Power Rating	900W	1200W	1800W	2500W	4000W	5500W
Power Factor	Unity					
No Load O/P Voltage	225V±10V					
Full Load O/P Voltage (Till Low Battery Alarm)	180V-210±10V			190V-210±10V		
No Load Battery Current	<2.5 AMP					
Full Load Battery Current	75±3A	100±3A	75±3A	105±3A	83±3A	110±3A
Over Load Battery Current	83A±3A	110A±3A	79A±3A	115A±3A	93±3A	120A±3A
Inverter Efficiency @ Nominal Battery Voltage	>75%		>80%		>80%	
O/P Frequency (No Load & Full Load)	50Hz ± 0.5Hz					
Low Battery Indication Voltage (Std Mode) @ Battery Terminal	10.7±0.25V		21.4V±0.5V		43.6V±1V	
Low Battery Shutdown Voltage (Std Mode) @ Battery Terminal	10.5±0.25V		21V±0.5V		42.8V±1V	
Low Battery Indication Voltage (High Mode) @ Battery Terminal	10.9±0.25V		21.8V±0.5V		43.6V±1V	
Low Battery Shutdown Voltage (High Mode) @ Battery Terminal	10.7±0.25V		21.4V±0.5V		42.8V±1V	
No Load & Full Load O/P Short Ckt Protection	Available					
Output Waveform	Pure Sine Wave					
Over Load Shut Down Protection	Available					
Over Temperature Protection	87°C ± 10°C			100°C ± 10°C		
Over Temperature Recovery	77.7°C ± 10°			90°C ± 10°		
Re-Tries During Battery Low Cut Off (Narrow Mode)	No Reset			No Reset		
Re-Tries During Battery Low Cut Off (Wide Mode)	No Reset			No Reset		
Manual Reset During Battery Low (Using On/Off Switch)	Power On/OFF switch available			Power On/OFF switch available (for 3 times)		
Re-Tries During Over Load (Narrow Mode)	No Reset					
Re-Tries During Over Load (Wide Mode)	Auto 5 Times					
Re-Tries During O/P Short Circuit Test	No Reset					

Product Specifications

MAINS MODE						
Mains Low Cut (Narrow Mode)						180V± 10V
Low Cut Recovery (Narrow Mode)						190V± 10V
Mains High Cut (Narrow Mode)						265V± 5V
High Cut Recovery (Narrow Mode)						255V± 10V
Mains Low Cut (Wide Mode)	90V± 10V			110V± 10V		
Low Cut Recovery (Wide Mode)	100V± 10V			120V± 10V		
Mains High Cut (Wide Mode)	300V± 10V			280V± 10V		
High Cut Recovery (Wide Mode)	285V± 10V			270V± 10V		
Battery Charging Boost Voltage High Mode @ 220Vac	14.5V± 0.25V		29V± 0.5V		58V± 1V	
Battery Charging Float Voltage High Mode @ 220Vac	13.8V± 0.25V	13.8V± 0.25V	27.6V± 0.5V		55.2V± 1V	
Battery Charging Boost Voltage Std Mode @ 220Vac	14.2V± 0.25V	14.2V± 0.25V	28.4V± 0.5V		56.8V± 1V	
Battery Charging Float Voltage Std Mode @ 220Vac	13.6V± 0.25V		27.2V± 0.5V		54.4V± 1V	
Battery Charging Current @ 220Vavc (Std Mode)						16A ± 2A
Battery Charging Current @ 220Vavc (High Mode)						18A ± 2A
Circuit Breaker trip @ Mains Mode						Available
Changeover From Mains To Backup (Ups Mode @ 200W Bulb Load)	<15ms	-	-	-	-	-
Changeover From Mains To Backup (Std Mode @ 200W Bulb Load)	<15ms	-	-	-	-	-
Changeover From Backup To Mains (Ups Mode @ 200W Bulb Load)	<15ms	-	-	-	-	-
Changeover From Backup To Mains (Std Mode @ 200W Bulb Load)	<15ms	-	-	-	-	-
Changeover From Mains To Backup (Ups Mode @ 400W Bulb Load)	-	-	<15ms	-	-	-
Changeover From Mains To Backup (Std Mode @ 400W Bulb Load)	-	-	<15ms	-	-	-
Changeover From Backup To Mains (Ups Mode @ 400W Bulb Load)	-	-	<15ms	-	-	-
Changeover From Backup To Mains (Std Mode @ 400W Bulb Load)	-	-	<15ms	-	-	-
Changeover From Mains To Backup (Ups Mode @ 800W Bulb Load)	-	-	-	<15ms	<15ms	<15ms
Changeover From Mains To Backup (Std Mode @ 800W Bulb Load)	-	-	-	<15ms	<15ms	<15ms
Changeover From Backup To Mains (Ups Mode @ 800W Bulb Load)	-	-	-	<15ms	<15ms	<15ms
Changeover From Backup To Mains (Std Mode @ 800W Bulb Load)	-	-	-	<15ms	<15ms	<15ms
PROTECTIONS						
Input Overload	Circuit Breaker			MCB		
Output Short Ckt	Electronic Current Limiting					
Battery Short Ckt	Fuse					
Output Over Load (Std Mode)	Complete Shut Down After 5 Reset					
Battery High Protection	15.5V±1V		31V±1V		62V±1V	
Air Condition Load Capacity	N/A	N/A	N/A	1 Ton Ac	2 Ton Ac	2 Ton Ac
Drain To Drain Short Ckt	Available					
Bulb Load Testing Criteria	Keep The System In Mains Mode @250V, Bulb Load Is 900W	Keep The System In Mains Mode @250V, Bulb Load Is 1800W	Keep The System In Mains Mode @250V, Bulb Load Is 1800W	Keep The System In Mains Mode @250V, Bulb Load Is 2500W	Keep The System In Mains Mode @250V, Bulb Load Is 4000W	Keep The System In Mains Mode @250V, Bulb Load Is 5500W
Weight	10.3 Kgs	11.67 Kgs	18.2 Kgs	27.6 Kgs	36.4 Kgs	39.9 Kgs
Display	LCM			LCD		

Product Specifications

VISUAL INDICATION		
Battery Voltage	Shows Battery Voltage	
Input Voltage	Shows Input Voltage	
Backup Mode	Battery Symbol, Battery Graph , Battery Voltage, Selected Mode (Narrow Or Wide)	UPS on, O/P voltage, battery voltage, O/P frequency, load %
Mains Mode	Mains Plug Symbol, Battery Graph , Input Voltage, Battery Voltage, Selected Mode (Narrow Or Wide)	AC Input Voltage, I/P Frequency, Battery Voltage, Battery Charging Condition,
Narrow/Wide Mode	Narrow & Wide Symbol	–
Short Circuit	Warning Symbol,Over Load Symbol Continue , Sct, Battery Symbol, Battery Graph, Selected Mode (Narrow Or Wide)	UPS Off short circuit
Over Load Alarm	Over Load Symbol , Warning Symbol, Battery Symbol, Battery Graph, Battery Voltage, Selected Mode (Narrow Or Wide)	Overload , Load % , Pls Reduce load
Over Load Shut Down	Over Load Symbol , Warning Symbol,Ovl, Battery Symbol, Battery Graph, Selectd Mode (Narrow Or Wide)	UPS Off Overload
Ckt Breaker Trip	Warning Symbol,Ckt Breaker Symbol , Cbt Battery Graph, Selected Mode (Narrow Or Wide)	MCB Trip, Pls RESET, Select Bypass
Low Battery Alarm	Battery Graph Blinks, Warning Symbol, Battery Voltage, Battery Symbol, Selected Mode (Narrow Or Wide)	Low Battery, Battery Voltage, Pls Reduce load
Low Battery Shut Down	Battery Symbol, Battery Graph, Warning Symbol, Lob, Selected Mode (Narrow Or Wide)	UPS Off, Low battery
Over Temperature Shut Down	Over Temperature Symbol , Warning Symbol , Otp, Battery Symbol, Battery Graph, Selected Mode (Narrow Or Wide)	Under Protection Over Temperature
Buzzer Mute Option	Switch Off The On/Off Switch And Then Buzzer Mute Symbol Continue Glow	Switch Off The On/Off Switch
Front Switch Off	Off, Selected Mode (Narrow Or Wide) , Buzzer Mute Symbol	AC Output Range, UPS Off
Welcome message	–	Shows Eastman welcomes you with model name
AUDIO INDICATION		
Over Load Occurs		Beep With Delay
Over Load Shut Down		No Beep
Low Battery Occurs		Beep With Delay
Low Battery Shut Down		No Beep
Over Temperature Shut Down		Continuous Beep
Short Circuit		Continuous Beep
Circuit Breaker trip		Continuous Beep
Buzzer Mute Option	Buzzer Can Be Muted Any Time During Any Audio Indication By Pressing On/Off Switch	





ONLINE UPS

1k / 2k / 3k

Certifications



LED Options

3 Kinds of LCD can be selected.



Colourful LCD



Blue LCD



Gray LCD

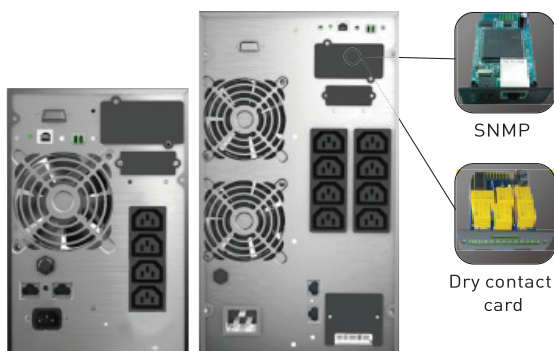

Rear panel

Introduction

powerhouse of reliability. With high power density, this UPS offers exceptional power output in a compact design, ensuring you get maximum energy efficiency without sacrificing space. Moreover, its compatibility with generators makes it a perfect companion, guaranteeing continuous and stable power supply even in the most demanding situations.

Product Features

- High power density.
- Online double conversion with full digital control.
- Wide input voltage range:110-300Vac.
- Input power factor 0.99 with PFC.
- Selectable output voltage: 208/220/230/240Vac.
- Smart charger design for optimized battery performance.
- Maximum charging current can be expanded to 12A (Long run unit).
- Emergency power off function (EPO).
- ECO mode operation for energy saving.
- Generator compatible.
- Cold start.
- Intelligent fan speed regulation.
- Load segment settable (Optional).
- Versatile LCD human-computer interface.
- Multiple communication interface: RS232 (USB/EPO/Dry contact /SNMP card optional).
- Multiple protection function: short-circuit, overload, overheat, battery overcharge and overdischarge, output low voltage and fan fault alarm.

Product Specifications

MODEL	EM 1K Online		EM 2K Online		EM 3K Online
Capacity	1000VA/ 900W		2000VA/ 1800W		3000VA/ 2700W
INPUT					
Nominal voltage	208/220/230/240Vac				
Input voltage range	110-300Vac (176-280Vac @ 100% load)				
Frequency range	40-70Hz (50/60Hz Auto-Sensing)				
Power factor	≥ 0.99				
OUTPUT					
Output voltage	208/220/230/240Vac				
Power factor	0.9				
Voltage regulation	±1%				
Output frequency	Line Mode	46-54Hz or 56-64Hz			
	Bat. Mode	(50/60±0.1%)Hz			
Crest factor	3:1				
Harmonic distortion (THDv)	≤ 3% Linear load				
	≤ 5% Non linear load				
Transfer time	AC mode to Bat.Mode	0ms			
	Inverter to Bypass	4ms (Typical)			
Output waveform	Pure Sinewave				
EFFICIENCY					
AC mode	88%		90%		91%
Battery mode	85%		87%		88%
BATTERY					
Battery number	2	3	4	6	6
Capacity (Standard unit)	9Ah/12V				
Typical recharging time	4 hours (to 90% of full capacity)				
Charging voltage	27.4Vdc±1%	41.1Vdc±1%	54.8Vdc±1%	82.2Vdc±1%	82.2Vdc±1%
Charging current (Max)	1A		1A		1A
INDICATORS					
LED display	Line mode,Bat.mode,ECO mode,Bypass mode,Battery low voltage,Overload & UPS fault				
LCD display	Input voltage,Input frequency,Output voltage,Output frequency,Load percentage, Battery voltage,Inner temperature& Remaining battery backup time				
ALARM					
Battery mode	Beeping every 4 seconds				
Battery low	Beeping every second				
Overload	Beeping twice every second				
Fault	Continuously beeping				
PHYSICAL					
Dimension W x D x H (mm)	144 x 399 x 209		191 x 460 x 337		
Net weight (kg)	9.3	12.5	19.5	24.5	24.5
ENVIRONMENT					
Operating temperature	0℃ ~40℃				
Storage temperature	-25℃ ~55℃				
Humidity range	20-95%RH @ 0-40℃ (Non condensing)				
Altitude	<1500m,derating required when>1500m				
Noise level	<50dB at 1 Meter				
STANDARDS					
Safety	IEC/EN62040-1,IEC/EN62477-1				
EMC	IEC/EN62040-2,IEC61000-4-2,IEC61000-4-3,IEC61000-4-4,IEC61000-4-5,IEC61000-4-6,IEC61000-4-8				

Specifications are subject to change without prior notice.
When output voltage is 208Vac,need to derate to 80% of the unit capacity.



ONLINE UPS

10k / 15k / 20k / 30k / 40k

Introduction

powerhouse of reliability. With high power density, this UPS offers exceptional power output in a compact design, ensuring you get maximum energy efficiency without sacrificing space. Moreover, its compatibility with generators makes it a perfect companion, guaranteeing continuous and stable power supply even in the most demanding situations.



Segment LCD

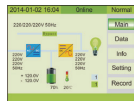

TFT colourful LCD



7 inch colourful LCD

Product Features

- High power density design
- N+X parallel redundancy, support maximum 4 units in parallel
- Online double conversion with DSP control
- Input current harmonic: <3%
- Wide input voltage range: 208-478Vac
- Wide input frequency range 40-70Hz
- Optimization battery group, the quantity of battery
10-30KVA: 16/18/20pcs (30-50pcs is optional)
- 40KVA: 30-50pcs
- Maximum charging current up to 20A (Settable)
- Dual input source (optional for standard unit)
- Colorful 2.4 inch TFT LCD display and 7 inch LCD display LCD are optional
- Versatile LCD human-computer interface
- Generator compatible
- ECO mode operation for energy saving
- Intelligent fan speed regulation
- Self-testing when UPS startup
- 50/60Hz frequency converter mode
- The output can meet 100% unbalanced load
- Multiple protection function: short-circuit, overload, overheat, battery overcharge and overdischarge, output low voltage and fan fault alarm
- Multiple communication interface: USB, RS232, RS485, Parallel port, Dry contact, Intelligent slot, SNMP card (Optional), Relay card (Optional), Battery temperature sensor (Optional)



Battery cabinet (Optional)



Optimized battery configuration
7Ah/9Ah (12V)



Relay card



SNMP

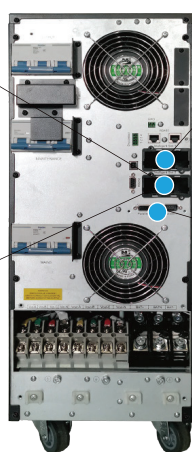

SNMP



Parallel cable

Technical Specifications:

MODEL	EM 10k S/H Online	EM 15k S/H Online	EM 20k S/H Online	EM 30k S/H Online	EM 40k S/H Online
Capacity	10kVA / 9kW	15kVA / 13.5kW	20kVA / 18kW	30kVA / 27kW	40kVA / 36kW
	10kVA / 10kW	15kVA / 15kW	20kVA / 20kW	30kVA / 30kW	40kVA / 40kW

INPUT

Nominal voltage	380/400/415Vac (3Ph+N+PE)
Operating voltage range	305~478Vac(Full load); 208~478Vac(50% load)
Operating frequency range	40~70Hz (50/60Hz Auto-Sensing)
Power factor	≥0.99
Bypass voltage range	Max.voltage:220V:+25% (Optional+10%,+15%,+20%) 230V:+20% (Optional+10%,+15%) 240V:+15% (Optional+10%) Min.voltage:-45% (Optional-20%,-30%)
Frequency protection range	50/60Hz ± 10%
ECO range	Same as bypass
Harmonic distortion (THDi)	≤3% Linear load

OUTPUT

Output voltage	380/400/415Vac (3Ph+N+PE)
Voltage regulation	± 1%
Power factor	0.9
Output	Line Mode ± 1%/ ± 2%/ ± 4%/ ± 5%/ ± 10% of the rated frequency (Optional)
Frequency	Bat. Mode 50/60(± 0.1%)Hz
Transfer time	AC mode to Bat.Mode 0ms
	Inverter to Bypass 0ms
Output waveform	Pure Sinewave
Crest factor	3:1
Harmonic distortion (THDv)	≤2% Linear load
	≤5% Non linear load
Overload	AC mode ≤110%,last 60min; ≤125%,last 10min; ≤150%,last 1min; >150% turn to bypass Immediately
	Bat.mode ≤110%,last 10min; ≤125%,last 1min; ≤150%,last 5s; >150% turn to bypass Immediately

EFFICIENCY

Efficiency	up to 93.5%	up to 94.5%
------------	-------------	-------------

BATTERY

	Standard unit	± 120Vdc (20pcs 12V9Ah); (20pcs 12V7Ah, 2x20pcs 12V7/9Ah optional)	± 120Vdc (2x20pcs 12V9Ah) (2x20pcs 12V7Ah optional)	± 120Vdc (3x20pcs 12V9Ah) (3x20pcs 12V7Ah optional)	± 180Vdc (2x30pcs 12V9Ah) (2x30pcs 12V7Ah optional)
Battery voltage	Long run unit	10~30kVA: ± 96/108/120Vdc; battery quantity(16~20pcs, 16pcs default, Standard unit and 20pcs no power derating;18pcs output power factor 0.8/0.9;16pcs output power factor 0.7/0.8;) 10~30kVA (Optional): ± 180/192/204/216/228/240/252/264/276/288/300Vdc (30/32/34/36/38/40/42/44/46/48/50pcs optional)			40kVA: ± 180/192/204/216 /228/240/252/264/276/288/ 300Vdc(30/32/34/36/38/40/ 42/44/46/48/50pcs)
Charge Current (charge current can be set according to battery capacity installed)	Standard unit	1.35A (2.7Aoptional)	2.7A	4.05A	2.7A
	Long run unit	14A Max.	16A Max.	18A Max.	20A Max.

PHYSICAL

Dimension	Standard unit	250 x 900 x 868
W × D × H (mm)	Long run unit	250 x 580 x 655
Net weight (kg)		129/35 186/39 187/40 236/43 239/46

ENVIRONMENTAL

Operating temperature	0 ~ 40°C
Storage temperature	-25 ~ 55°C (No battery)
Humidity range	0 ~ 95% (Non condensing)
Altitude	<1500m,derating required when>1500m
Noise level	<55dB <58dB <61dB <64dB

STANDARDS

Safety	IEC/EN62040-1,IEC/EN62477-1
EMC	IEC/EN62040-2,IEC61000-4-2,IEC61000-4-3,IEC61000-4-4,IEC61000-4-5,IEC61000-4-6,IEC61000-4-8

Specifications are subject to change without prior notice.

BT 10–40kVA battery pack specification

MODEL	EM BT40120	EM20 BT80120	EM30 BT80120	EM40 BT60180	EM40 BT80420
BATTERY SYSTEM					
Battery type	VRLA (Lead acid maintenance free battery)				
Typical battery recharging time	6–8 hours (to 90% of full capacity)				
Typical battery life	3–5 years, depend on discharging cycle and ambient temperature				
System voltage	± 120Vdc		± 180Vdc		± 240Vdc
Battery quantity	2 * ± 10 PCS	4 * ± 10 PCS		2 * ± 15 PCS	2 * ± 20 PCS
Capacity	7Ah/9Ah (12V)				
PHYSICAL					
Dimension W x D x H (mm)	250 x 619 x 616 (With wheel)		250 x 900 x 868 (With wheel)		
Net weight (kg)	122/134	244/265		200/215	244/265
ENVIRONMENT					
Safety	CE				
Operating environment	0°C ~40°C				
Relative humidity	0–95% (Non condensing)				
Noise level	<40dB at 1 Meter				

Specifications are subject to change without prior notice.

Remark: YDC3340 BT80240N "YDC3340" means series; "BT": means Battery Tower cabinet; "80" means battery number inside the cabinet; "240" means the battery system voltage; "N" means battery with neutral connection.





ONLINE UPS

6k / 10k

6k Pro / 10k Pro

Introduction

powerhouse of reliability. With high power density, this UPS offers exceptional power output in a compact design, ensuring you get maximum energy efficiency without sacrificing space. Moreover, its compatibility with generators makes it a perfect companion, guaranteeing continuous and stable power supply even in the most demanding situations.

Certifications



3 Kinds of LCD can be selected.



Colourful LCD



Blue LCD



Gray LCD



Parallel board

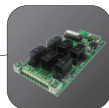

Relay card



SNMP

Product Features

- Online double conversion with full digital control.
- Optimization battery group, the quantity of battery: 16/18/20pcs (Settable).
- Wide input voltage range:110-286Vac.
- Input power factor 0.99 with PFC.
- Output Power Factor 0.9.
- Wide input frequency range.
- Selectable output voltage: 208/220/230/240Vac.
- Generator compatible.
- ECO mode operation for energy saving.
- Self-testing when UPS startup.
- Multiple communication interface: RS232/USB/EPO(Dry contact/SNMP card optional).
- Cold start, Emergency Power off function.
- Design with maintenance switch (Optional).
- Intelligent fan speed regulation.
- Multiple protection function: short circuit, overload, overheat, battery overcharge and overdischarge, output low voltage and fan.

Additional Features For Pro Version

- N+X parallel redundancy, support maximum 4 units in parallel
- Maximum charging current up to 10A

Technical Specifications:

MODEL		EM 6K Online	EM 10K Online
Capacity		6000VA/ 5400W	10000VA/ 9000W
INPUT			
Nominal voltage		208/220/230/240Vac	
Input voltage range		110~286Vac	
Frequency range		40~70Hz (50/60Hz Auto-Sensing)	
Power factor		≥ 0.99	
Bypass voltage range		Max.voltage:230~264Vac Min.voltage:176~220Vac	
OUTPUT			
Output voltage		208/220/230/240Vac	
Power factor		0.9	
Voltage regulation		±1%	
Output frequency	Line Mode	±10% of the rated frequency	
	Bat. Mode	(50/60±0.1%)Hz	
Crest factor		3:1	
Harmonic distortion (THDv)		≤ 2% Linear load ≤ 5% Non linear load	
Transfer time	AC mode to Bat.Mode	0ms	
	Inverter to Bypass	5ms (Typical)	
Output waveform		Pure Sinewave	
Overload	Line Mode	Load ≤ 105% long time running; ≤ 125% last 10min; ≤ 130% last 30s; >130% turn to bypass mode immediately	
	Bypass Mode	40A (Breaker)	63A (Breaker)
Efficiency		93.5%	
BATTERY			
Battery voltage		192/216/240Vdc (Adjustable) ,without neutral	
Capacity (Standard unit)		9Ah/12V (7Ah/12V optional)	
Typical recharging time		6~8 hours (to 90% of full capacity)	
Charging current		1A (Standard unit); Long run unit Max.current 8A (Charging current can be set according to battery capacity)	
INDICATORS			
LED display		Line mode,Bat.mode,ECO mode,Bypass mode,Battery low voltage,Overload & UPS fault	
LCD display		Input voltage,Input frequency,Output voltage,Output frequency,Load percentage, Battery voltage,Inner temperature& Remaining battery backup time	
ALARM			
Battery mode		Beeping every 4 seconds	
Battery low		Beeping every second	
Overload		Beeping twice every second	
Fault		Continuously beeping	
PHYSICAL			
Dimension W x D x H (mm)		H:191 x 460 x 337;S:191 x 460 x 720 (With wheel)	
Net weight (kg)		69.5	71
ENVIRONMENT			
Operating temperature		0℃~ 40℃	
Storage temperature		-25℃ ~55℃	
Humidity range		20~95%RH @ 0~40℃ (Non condensing)	
Altitude		<1500m,derating required when>1500m	
Noise level		<55dB at 1 Meter	<58dB at 1 Meter
STANDARDS			
Safety		IEC/EN62040-1,IEC/EN 62477-1	
EMC		IEC/EN62040-2,IEC61000-4-2,IEC61000-4-3,IEC61000-4-4,IEC61000-4-5,IEC61000-4-6,IEC61000-4-8	

Specifications are subject to change without prior notice.

When output voltage is 208Vac,need to derate to 80% of the unit capacity.

Technical Specifications:

MODEL	EM Pro 6k Online	EM Pro 10k Online
Capacity	6000VA/5400W	10000VA/9000W
INPUT		
Nominal voltage	208/220/230/240Vac	
Input voltage range	110 – 286Vac	
Power factor	≥0.99	
Bypass voltage range	Max.voltage: 220V: +25% (Optional +10%, +15%, +20%) 230V: +20% (Optional +10%, +15%) 240V: +15% (Optional +10%) Min.voltage: -45% (Optional -20%, -30%)	
FREQUENCY		
Frequency range	40 ~ 70Hz (50/60Hz Auto-Sensing)	
OUTPUT		
Output voltage	208/220/230/240Vac	
Voltage regulation	±1%	
Power factor	0.9	
Output frequency	±1%/±2%/±4%/±5%/±10% of the rated frequency (Optional)	
	Line mode	(50/60±0.1%)Hz
	Bat. mode	
Crest factor	3:1	
Harmonic distortion (THDv)	≤2% Linear load ≤5% Non linear load	
Transfer time	AC mode to Bat.mode	0ms
	Inverter to Bypass	0ms
Output waveform	Pure Sinewave	
Overload	Line mode	Load ≤110% last 60min; ≤125% last 10min; ≤150% last 1min; >150% turn to bypass mode immediately
	Bypass mode	40A (Breaker) / 63A (Breaker)
Efficiency	up to 93.5%	
BATTERY		
Battery voltage	±120Vdc	
Capacity (Standard unit)	9Ah/12V (7Ah/12V optional)	
Typical recharging time	6 ~ 8 hours (To 90% of full capacity)	
Charging current	1.35A (Standard unit); Long run unit Max.current 10A (Charging current can be set according to battery capacity)	
INDICATORS		
LED display	Line mode, Bat.mode, ECO mode, Bypass mode, Battery low voltage, Overload & UPS fault	
LCD display	Input voltage, Input frequency, Output voltage, Output frequency, Load percentage, Battery voltage, Inner temperature & Remaining battery backup time	
ALARM		
Battery mode	Beeping every 4 seconds	
Battery low	Beeping every second	
Overload	Beeping twice every second	
Fault	Continuously beeping	
PHYSICAL		
Dimension W × D × H	H: 191 × 460 × 337mm; S: 191 × 460 × 720mm (With wheel)	
Net weight	70kg	71.5kg
ENVIRONMENT		
Operating temperature	0°C ~ 40°C	
Storage temperature	-25°C ~ 55°C	
Humidity range	20 ~ 95%RH @ 0 ~ 40°C (Non condensing)	
Altitude	< 1500m, derating required when > 1500m	
Noise level	< 55dB at 1 Meter	< 58dB at 1 Meter
STANDARDS		
Safety	IEC/EN 62040-1, IEC/EN 62477-1	
EMC	IEC/EN 62040-2 (IEC 61000-4-2, IEC 61000-4-3, IEC 61000-4-4, IEC 61000-4-5, IEC 61000-4-6, IEC 61000-4-8, IEC 61000-4-11, IEC 61000-2-2)	

1. When output voltage is 208Vac, need to derate to 80% of the unit capacity
2. Specifications are subject to change without prior notice
3. Data above are typical values for reference only, not as a basis for engineering design



SURGE PROTECTOR

EMSP6W / EMSP6WUSB

EMSP6W / EMSP6W USB

Max. 2500W Max.10A 250V-
USB Output DC 5V, Total max.4.2A

Technical Specifications

- Rated Voltage 230/110VAC.
- Frequency 50/60Hz.
- Rated Current 10A Max (Single Phase).
- Power Indicator Neon Type.
- Output Socket 6X Universal Type.
- Ensure that the maximum load is less than 10Amp.
- Don't use in wet, damp or moist conditions.
- Don't use if the plug, lead or the socket is damaged.
- Tee years warranty Failure to comply with installation and safety instruction voids the warranty.

Introduction

Eastman Surge Protector is an essential shield for your electronics. Featuring universal output sockets for seamless compatibility and a fireproof design, ensuring safety and durability against electrical faults or surges.

Product Features

- Max Load (2300W(230V 10A)).
- Universal Output Sockets.
- Surge & Thunder Protection.
- EMI/RFI Filters Protection.
- Circuit Overload Breaker Protection.
- Fire Proof Design.
- 10,000 cycles push-button switch.
- Long life span with 5,000 cycles insertion.
- High-temperature and fire resistant plastic material.
- Highly conductive Integrated brass bar.
- German VDE certified 3* 1.0mm cable.

Environment

- Operating Temp : -20C ~ 90C.
- Storage Temp : 35C ~ 95C.
- Humidity : - ~ 95% RH (non-condensing).

Product Specifications

(200 ~ 230VAC) POWER CONSUMPTION CHART	
Hair Dryer	1000W
Iron	750W
Fax Machine	55W
Inkjet Printer	52W
PC	180-300W
LCD TV	40-60W
DVD Player	25W
Video Cassette Player	40W
Mixer	100-140W
Refrigerator	800-1200W



www.eastmanworld.com
marketing@eastmanworld.com

AMPS MIDDLE EAST FZ LLC

#703, 7TH Floor, Deira Twin Tower,
Baniyas Square, Deira, Dubai (UAE)

EASTMAN AUTO & POWER LTD.

ASF Towers, 249, Udyog Vihar Phase-4, Gurugram,
Haryana-122016, India

GUANGDONG EASTMAN NEW ENERGY CO., LTD

#1602, Meilan business centre, Intersection of Xixiang Avenue
and Qianjin Second Road, Bao'an, District, Shenzhen-518102, China

Follow us on »  @eastman_world  @EastmanWorld  @EastmanWorld