



The **WISE** Choice



Sealed
Maintenance Free



Superior
Quality



Low
Corrosion



Longer
Life

A U T O M O T I V E B A T T E R Y



Why Choose **Eastman**

Customer-Centric Excellence: Where You Come First, Every Time.

Our customers are the heartbeat, igniting our commitment to providing products and services that deeply resonate, bringing both genuine benefit and inspiration.

Premium Quality Assurance: Performance Unleashed, Quality Assured.

Eastman ensures the finest components for optimal performance. Our 12-step quality control ensures unparalleled quality, leading to one of the industry's lowest claim ratios.

Unmatched Variety of Automotive Batteries: Powering Your Drive, Tailored to Your Needs.

Whether you own a fleet or a private car, Eastman provides the perfect battery solution. Our diverse range caters to all, ensuring cost-effectiveness and reliability for every journey.

Continuous Evolution: Innovation Never Rests, Neither Do We.

Eastman goes beyond mere growth, focusing on continuous improvement in technology and features. Our commitment to environmental friendliness ensures a sustainable and evolving product line.

Support and Service: More Than Service, It's a Connection

Our support and service stand as pillars of this heartfelt dedication, ensuring your journey with Eastman is not just a transaction but an emotional connection.

Trust Eastman for Excellence and Sustainability: Driving Trust, Shaping Tomorrow.

Eastman is your partner for a journey fuelled by excellence and sustainability. Trust us to deliver products that not only meet your expectations but also contribute to a greener, more sustainable future.

OUT-PERFORMING STATE-OF-THE-ART TECHNOLOGY

- The positive plate is made using **grid cast technology**.
- The negative plate is made using **expanded grid technology**.
- Thicker grid which leads to a longer life of the battery as compared to competition, which also results to **low corrosion**.

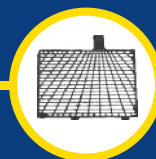

Advanced
Grid Design



Glass Mat
Assembly



Positive Plate
Hybrid Grid Casting

- Delivers higher corrosion resistance and has a **longer life span** at high temperature due to the high content of Sn (tin) in the grid alloy.
- Made with **C21 alloy technology**.
- **Double clad separation**-high reliability and life expectancy.
- Special side vented cover design – **Excellent spill – resistant** characteristics.

AUTOMOTIVE BATTERY SPECIFICATION



MADE IN INDIA

JIS BATTERIES									
Sr.No.	Model No.	AH	Dimension (mm, L x W x H)	CCA	RC	Cell Layout	Terminal Shape	Base Hold	Pallet Qty
1	44B20L	35	197 X 127 X 227 (mm)	332	54	0	T1	W & W/O BH	160
2	44B20R	35	197 X 127 X 227 (mm)	332	54	1	T1	W & W/O BH	160
3	40B24L	40	238 X 129 X 227 (mm)	250	40	0	T1	W/O BH	135
4	40B24R	40	238 X 129 X 227 (mm)	250	40	1	T1	W/O BH	135
5	40B24LS	40	238 X 129 X 227 (mm)	250	40	0	T1	W/O BH	135
6	40B24RS	40	238 X 129 X 227 (mm)	250	40	1	T1	W/O BH	135
7	60B24L	45	238 X 129 X 227 (mm)	410	71	0	T1	W/O BH	135
8	60B24R	45	238 X 129 X 227 (mm)	410	71	1	T1	W/O BH	135
9	60B24LS	45	238 X 129 X 227 (mm)	410	71	0	T2	W/O BH	135
10	60B24RS	45	238 X 129 X 227 (mm)	410	71	1	T2	W/O BH	135
11	55D23L	60	232 X 172 X 225 (mm)	500	100	0	T2	W & W/O BH	100
12	55D23R	60	232 X 172 X 225 (mm)	500	100	1	T2	W & W/O BH	100
13	75D23L	62	232 X 172 X 225 (mm)	420	105	0	T2	W & W/O BH	100
14	75D23R	62	232 X 172 X 225 (mm)	420	105	1	T2	W & W/O BH	100
15	48D26L	50	260 X 173 X 225 (mm)	340	76	0	T2	W & W/O BH	100
16	48D26R	50	260 X 173 X 225 (mm)	340	76	1	T2	W & W/O BH	100
17	55D26L	60	260 X 173 X 225 (mm)	500	100	0	T2	W & W/O BH	100
18	55D26R	60	260 X 173 X 225 (mm)	500	100	1	T2	W & W/O BH	100
19	65D26L	65	260 X 173 X 225 (mm)	510	104	0	T2	W & W/O BH	100
20	65D26R	65	260 X 173 X 225 (mm)	510	104	1	T2	W & W/O BH	100
21	80D26L	70	260 X 173 X 225 (mm)	600	120	0	T2	W & W/O BH	100
22	80D26R	70	260 X 173 X 225 (mm)	600	120	1	T2	W & W/O BH	100
23	65D31L	70	305 X 173 X 225 (mm)	510	126	0	T2	W & W/O BH	85
24	65D31R	70	305 X 173 X 225 (mm)	510	126	1	T2	W & W/O BH	85
25	75D31L	75	305 X 173 X 225 (mm)	580	137	0	T2	W & W/O BH	85
26	75D31R	75	305 X 173 X 225 (mm)	580	137	1	T2	W & W/O BH	85
27	95D31L	80	305 X 173 X 225 (mm)	650	140	0	T2	W & W/O BH	85
28	95D31R	80	305 X 173 X 225 (mm)	650	140	1	T2	W & W/O BH	85
29	105D31L	90	305 X 173 X 225 (mm)	750	155	0	T2	W & W/O BH	85
30	105D31R	90	305 X 173 X 225 (mm)	750	155	1	T2	W & W/O BH	85
31	115D31L	95	305 X 173 X 225 (mm)	750	155	0	T2	W & W/O BH	85
32	115D31R	95	305 X 173 X 225 (mm)	750	155	1	T2	W & W/O BH	85
33	95E41R	100	410 X 176 X 233 (mm)	640	182	1	T2	W/O BH	60
34	MF120	120	505 X 182 X 240 (mm)	680	228	4	T2	W/O BH	45
35	HMF150	150	508 X 222 X 257 (mm)	785	285	4	T2	W/O BH	32
36	MF 170	170	512 X 212 X 240 (mm)	810	290	4	T2	W/O BH	32
37	MF 190	190	508 X 222 X 240 (mm)	845	300	4	T2	W/O BH	32
38	HMF200	200	521 X 278 X 270 (mm)	950	421	4	T2	W/O BH	24
39	HMF200 (1150)	200	521 X 278 X 270 (mm)	1150	421	4	T2	W/O BH	24
40	MF 200 Z	215	521 X 278 X 242 (mm)	1010	380	4	T2	W/O BH	24
DIN BATTERIES									
41	DIN 44L	44	207 X 175 X 190 (mm)	360	65	0	T2	BH	120
42	DIN 44R	44	207 X 175 X 190 (mm)	360	65	1	T2	BH	120
43	DIN55L	55	243 X 175 X 190 (mm)	420	82	0	T2	BH	100
44	DIN55R	55	243 X 175 X 190 (mm)	420	82	1	T2	BH	100
45	DIN60L	60	243 X 175 X 190 (mm)	420	90	0	T2	BH	90
46	DIN62L	62	243 X 175 X 190 (mm)	420	90	0	T2	BH	90
47	DIN62R	62	243 X 175 X 190 (mm)	420	90	1	T2	BH	90
48	DIN66L	66	278 X 175 X 190 (mm)	510	105	0	T2	BH	90
49	DIN66R	66	278 X 175 X 190 (mm)	510	105	1	T2	BH	90
50	DIN74L	74	278 X 175 X 190 (mm)	570	115	0	T2	BH	90
51	DIN74R	74	278 X 175 X 190 (mm)	570	115	1	T2	BH	90
52	DIN80L	80	313 X 175 X 190 (mm)	750	157	0	T2	W/O BH	75
53	DIN90L	90	353 X 175 X 190 (mm)	800	160	0	T2	W/O BH	60
54	DIN100L	100	353 X 175 X 190 (mm)	750	176	0	T2	W/O BH	60
55	DIN 170	170	513 X 223 X 223 (mm)	940	356	3	T2	W/O BH	24
56	DIN180	180	513 X 223 X 223 (mm)	940	356	3	T2	W/O BH	24
57	DIN225L	225	518 X 275 X 244 (mm)	1050	415	3	T2	W/O BH	24
EFB BATTERIES									
58	EFB 44B20	35	197 X 127 X 227 (mm)	280		0,1	T1	W & W/O BH	160
59	EFB 60B24	45	238 X 129 X 227 (mm)	380		0,1	T1	W/O BH	135
60	EFB 55D23	60	232 X 172 X 225 (mm)	470		0,1	T2	W & W/O BH	100
61	EFB 48D26	50	260 X 173 X 225 (mm)	420		0,1	T2	W & W/O BH	100
62	EFB 80D26	70	260 X 173 X 225 (mm)	590		0,1	T2	W & W/O BH	100
63	EFB 105D31	90	305 X 173 X 225 (mm)	720		0,1	T2	W & W/O BH	85
64	EFB MF100	100	410 X 176 X 233 (mm)	680		0,1	T2	W/O BH	60
65	EFB MF120	120	505 X 182 X 240 (mm)	780		3,4	T2	W/O BH	45
66	EFB DIN44	44	210 X 175 X 190 (mm)	360		0,1	T2	BH	120
67	EFB DIN55	55	243 X 175 X 190 (mm)	430		0,1	T2	BH	100
68	EFB DIN60	60	243 X 175 X 190 (mm)	470		0,1	T2	BH	100
69	EFB DIN72	72	278 X 175 X 175 (mm)	560		0,1	T2	BH	90
70	EFB DIN80	80	313 X 175 X 190 (mm)	750		0	T2	W/O BH	75
71	EFB DIN100	100	353 X 175 X 190 (mm)	800		0	T2	W/O BH	60
72	EFB DIN150	170	513 X 224 X 220 (mm)	850		3,4	T2	W/O BH	24
73	EFB DIN170	170	513 X 224 X 220 (mm)	900		3,4	T2	W/O BH	24
74	EFB DIN200	200	521 X 278 X 242 (mm)	950		3,4	T2	W/O BH	24
75	EFB DIN225	225	518 X 275 X 244 (mm)	1050		3,4	T2	W/O BH	24

• Key to Battery Layout

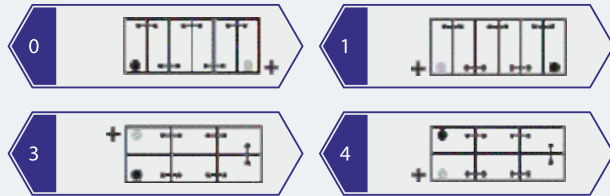

The CCA Values are at service gravity $1.280 \pm 0.001 @ 27^{\circ} \text{C}$

• Terminals

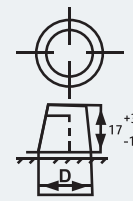

Types of Terminals	Tip Diameter (F.D)	
	Positive (mm)	Negative (mm)
T1	14.70 -0.3	13.00 -0.3
T2	19.50 -0.3	17.90 -0.3

MAINTENANCE



01. The battery should be charged if it is kept idle for more than three months.



02. The vent holes on both sides of the battery upper cover or on the vent plug should be checked regularly. Keep the holes from being blocked by dust and ice water to avoid poor exhaust, shell deformation and burst.



03. The battery can't be used any more if the battery terminals are burned.

04. Test the reserved capacity firstly during the test of battery performance.



05. For batteries with indicator, if the indicator turns white during use, it may caused by the bubbles around the indicator ball. Shake the battery carefully, if the indicator turns green, it means the battery can still be used. If the indicator keeps white, the battery is in lack of electrolyte. Then the battery should be replaced.



06. Don't use the electric equipments in the car for a long time if the car generator is not working, like the lamps, air conditioners and audio. Otherwise the battery will deeply discharge. The battery lifetime will be reduced, and the car may can't be started.

07. Usually it takes 3 to 5 seconds to start a car at first time. The restarting should be at intervals of more than 15 seconds. If the car fails to be started after many times, you need to check if there is any damage on the battery or the circuit. This situation usually happens in winter.

08. We can't avoid the natural electric lose caused by the vehicle load. So if the car will be parked for more than 10 days, pls break the negative connection wire of the battery to avoid electric lose caused by the vehicle load and deep discharging.





www.eastmanworld.com
marketing@eastmanworld.com

AMPS MIDDLE EAST FZ LLC
#703 - 704, 7TH Floor, Deira Twin Tower,
Baniyas Square, Deira, Dubai (UAE)

EASTMAN AUTO & POWER LTD.
ASF Towers, 249, Udyog Vihar Phase-4,
Gurugram, Haryana-122016, India

GUANGDONG EASTMAN NEW ENERGY CO., LTD
#1602, Meilan business centre,
Intersection of Xixiang Avenue and
Qianjin Second Road, Bao'an, District,
Shenzhen-518102, China

Follow us on »

@eastman_world @EastmanWorld @EastmanWorld