



The **WISE** Choice

## EASTMAN WORLD

---

Welcome to Eastman World - Your Global Partner in Energy Solutions!



## LITHIUM BATTERIES

---

WALL MOUNTED | FLOOR MOUNT |  
RACK TYPE

MADE IN INDIA



# Eastman Introduction

**Founded in 2006**

Established in 2006, Eastman Auto & Power Limited is a well-known name in the field of Solar Energy, Energy Storage and Power Electronics, boasting a USD 300 million revenue with a dedicated workforce of over 3,000 professionals. Building on the group's decades-long success and maintaining the trust of our partners, Mr. Jagdish Rai Singal ventured into the future of energy with Eastman Auto & Power Limited. Today, the business spans over 50 countries across Asia, Middle East, Africa and Americas, providing the world with cutting-edge products that have set new benchmarks in their respective segments. Driven by innovation, we continually set industry standards ensuring uninterrupted power supply for Residential, Commercial and Industrial applications.

Our Global Solar distribution business provides reliable and high-quality Solar solutions including Solar Inverters, Solar Batteries (Tubular, Carbon, Gel and Lithium), Solar Pump Inverters, Solar Charge Controllers, Solar Panels and more. Our products offer a range of solutions to help you make the switch to clean energy. With us as your unwavering partners, we forge a sustainable future amplifying global excellence through transformative products and services.



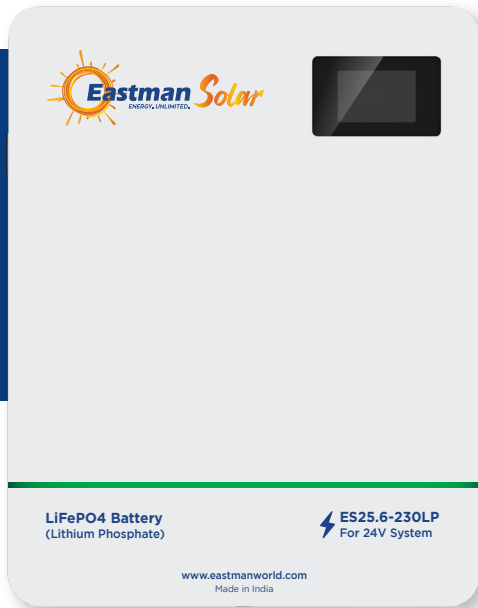

**MADE IN INDIA**

## RESIDENTIAL ES25.6V LiFePO4 (Lithium Phosphate) ENERGY STORAGE BATTERY

### Introduction

Upgrade your Energy Storage with our Lithium Phosphate Battery. Stay informed with real-time operation status via the LCD Screen, ensuring total control and efficiency for your power requirements.

### Product Features

- Real-time monitoring of operation status by LCD Screen.
- Intelligent Air Cooling & Heat dissipation.
- RS485/CAN Communication for connecting more batteries in parallel.
- Installation option: Wall mount.

### Certifications



### Connection Diagram

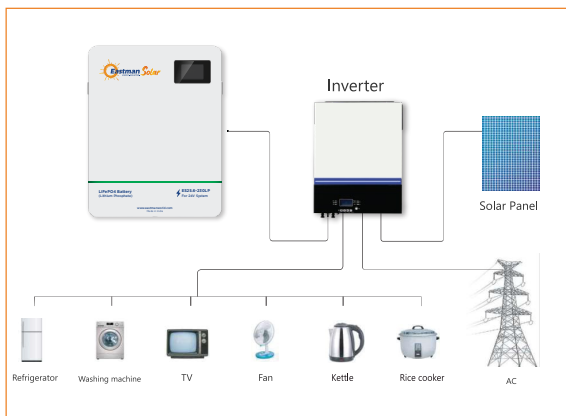

### Product Specifications

Model	ES25.6-100LP	ES25.6-230LP
Array Mode		8S
Nominal Energy (kWh)	2.5	5.8
Nominal Voltage (V)		25.6
Charge Voltage (V)		29.2
Discharge Cut-off Voltage (V)		21
Standard Charging Current(A)	20	46
Max. Continuous Charging Current (A)		100
Max. Continuous Discharging Current (A)		100
Cycle Life	6000 Cycles @80% DOD @25°C @0.2C/0.2C	
Communication Mode	RS485/CAN, RS232, RS485/RS485	
Operating Temp	Charging: 0~60°C; Discharging: -10°C~65°C	
Size(LxWxH) mm	440x170x350	560x470x170
Net Weight (kg)	~23	~45
Gross Weight (kg)	~25	~47
Warranty	5 Years	



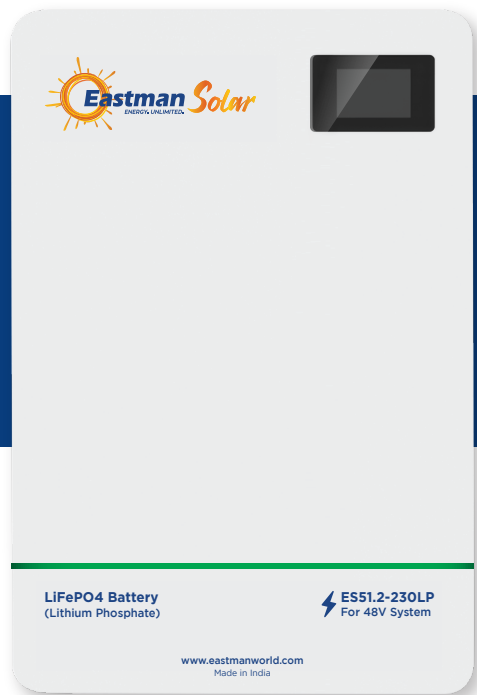

**MADE IN INDIA**

## RESIDENTIAL ES51.2V LiFePO4 (Lithium Phosphate) ENERGY STORAGE BATTERY

### Introduction

Upgrade your Energy Storage with our Lithium Phosphate Battery. Stay informed with real-time operation status via the LCD Screen, ensuring total control and efficiency for your power requirements.

### Product Features

- Real-time monitoring of operation status by LCD Screen.
- Intelligent Air Cooling & Heat dissipation.
- RS485/CAN Communication for connecting more batteries in parallel.
- Installation option: Wall mount.

### Certifications



### Connection Diagram

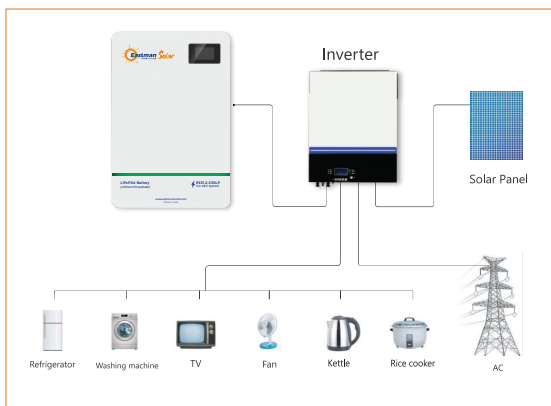

### Product Specifications

Model	ES51.2-100LP	ES51.2-230LP
Array Mode	16S	
Nominal Energy (kWh)	5.1	11.7
Nominal Voltage (V)	51.2	
Charge Voltage (V)	58.4	
Discharge Cut-off Voltage (V)	42	
Standard Charging Current(A)	20	46
Max. Continuous Charging Current (A)	100	200
Max. Continuous Discharging Current (A)	100	200
Cycle Life	6000 Cycles @80% DOD @25°C @0.2C/0.2C	
Communication Mode	RS485/CAN, RS232, RS485/RS485	
Operating Temp	Charging: 0~60°C; Discharging: -10°C~65°C	
Size(LxWxH) mm	560x470x170	670x485x244
Net Weight (kg)	~41	~93
Gross Weight (kg)	~43	~106
Warranty	5 Years	

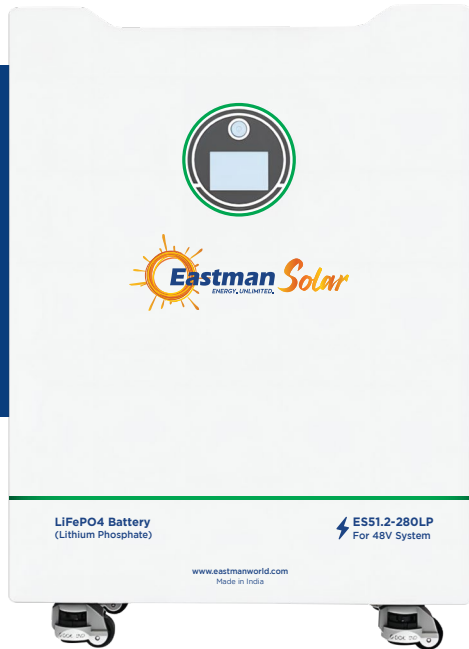

# RESIDENTIAL ES51.2V LiFePO4 (Lithium Phosphate) ENERGY STORAGE BATTERY

**MADE IN INDIA**

## Certifications



## Structural Part Description

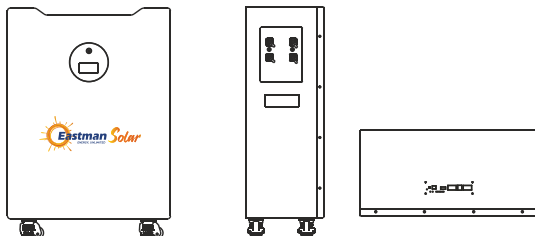

## Introduction

Upgrade your Energy Storage with our Lithium Phosphate Battery. Stay informed with real-time operation status via the LCD Screen, ensuring total control and efficiency for your power requirements.

## Product Features

- LCD Display for monitoring energy storage, power data and operating status.
- High-Quality LiFePo4 Battery for Deep Cycle and Long Lifespan.
- Metal Casing that ensures waterproof and explosion-proof safety.
- External Main Switch to reduce product power consumption and improve safety.
- Mobile bottom wheels designed for easy installation across various locations with ease.
- In-built BMS for Over-Voltage, Over-Load and Over-Temperature protection.
- Compatible - It can be connected to different types of loads within the voltage range.
- Supports upto 15 modules in parallel.
- Installation option: Floor mount.

## Product Specifications

Model	ES51.2-280LP
Array Mode	16S
Nominal Energy (kWh)	14.3
Nominal Voltage (V)	51.2
Charge Voltage (V)	58.4
Discharge Cut-off Voltage (V)	42
Standard Charging Current(A)	56
Max. Continuous Charging Current (A)	200
Max. Continuous Discharging Current (A)	200
Cycle Life	6000 Cycles @80% DOD @25°C @0.5C/0.5C
Communication Mode	RS485/CAN, RS232, RS485/RS485
Operating Temp	Charging: 0~60°C; Discharging: -10°C~65°C
Size(LxWxH) mm	750x580x279
Net Weight (kg)	~113
Gross Weight (kg)	~128
Warranty	5 Years



**MADE IN INDIA**



**MADE IN INDIA**

### Certifications



### Applications

- Telecom
- UPS
- Emergency Light
- Solar System
- Wind Power

### Product Specifications

Model	ES51.2-100BS	ES51.2-400BS
Array Mode	16S	16S x4 (Module)
Nominal Energy (kWh)	5.1	20.0
Nominal Voltage (V)	51.2	
Charge Voltage (V)	58.4	
Discharge Cut-off Voltage (V)	42	
Standard Charging Current(A)	20	20x4
Max. Continuous Charging Current (A)	100	100x4
Max. Continuous Discharging Current (A)	100	100x4
Cycle Life	6000 Cycles @80% DOD @25°C @0.2C/0.2C	
Communication Mode	RS485/CAN	
Operating Temp	Charging: 0~60°C; Discharging: -10°C~65°C	
Size(LxWxH) mm	520x495x175	600x600x1000 (with cabinet)
Net Weight (kg)	~44	~200
Gross Weight (kg)	~46	~210
Warranty	5 Years	

# RACK TYPE LITHIUM ENERGY STORAGE BATTERY

### Introduction

Optimize your Energy Solution with our Rack-Type Energy Storage. Featuring advanced warning functions for secure and dependable operation in all conditions.

### Product Features

- Standardized Design: Our 3U and 4U standardized case ensures broad applicability.
- Enhanced Energy Capacity: Support multiple parallel battery usage to meet high energy demands.
- Intelligent Lithium Battery Management System: Equipped with RS485 communication, offers real-time battery monitoring and customizable protection parameters such as charge & discharge.
- Balancing: Automatic collection of battery single series voltage, pressure difference up to 30 Mega Volt (can be set) with an automatic start equalization function.
- Warning Function: Advanced warning functions, including Overcharge, Over-Discharge, Over-Current, High-Temperature and Low-Temperature alerts reducing potential safety risks.



[www.eastmanworld.com](http://www.eastmanworld.com)  
[marketing@eastmanworld.com](mailto:marketing@eastmanworld.com)

**AMPS MIDDLE EAST FZ LLC**

#703, 7<sup>TH</sup> Floor, Deira Twin Tower,  
Baniyas Square, Deira, Dubai (UAE)

**EASTMAN AUTO & POWER LTD.**

ASF Towers, 249, Udyog Vihar Phase-4, Gurugram,  
Haryana-122016, India

**EASTMAN NEW ENERGY PRIVATE LIMITED**

Plot No 264, Sector-7, IMT Manesar, District - Gurugram  
Haryana-122050, India

Follow us on »  @eastman\_world  @EastmanWorld  @EastmanWorld